

VENTOSAS
VACUUM CUPS

PROFUNDAS
DEEP

VSA II



CARACTERÍSTICAS · CHARACTERISTICS

Ø reposo / Ø trabajo <i>Ø unloaded / Ø loaded</i>	[mm]
Mín. radio de curvatura <i>Minimum curve radius</i>	[mm]
Carrera máxima <i>Maximum stroke</i>	[mm]
Volumen <i>Volume</i>	[cm³]
Peso <i>Weight</i>	[g]
Fuerza a -0,4 bar <i>Force at -0,4 bar</i>	[Kgf]
Fuerza a -0,6 bar <i>Force at -0,6 bar</i>	[Kgf]
Fuerza a -0,8 bar <i>Force at -0,8 bar</i>	[Kgf]
Fuerza a -0,9 bar <i>Force at -0,9 bar</i>	[Kgf]

CÓMO PEDIR · HOW TO ORDER

● Ventosa de nitrílico con racor integrado
Nitrile vacuum cup with integrated fitting

ADECUADAS PARA
SUITABLE FOR

VENTAJAS
ADVANTAGES

Superficies esféricas
Spherical surfaces

Superficies curvadas
Curved surfaces

Forma cóncava profunda
Deep concave shape

Estructura robusta
Sturdy structure

Racor integrado
Integrated fitting

Ø 45

Ø 45 M14

Ø 62

Ø 80

Ø 115

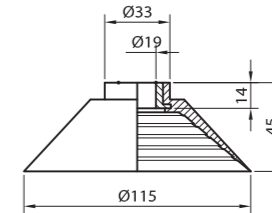
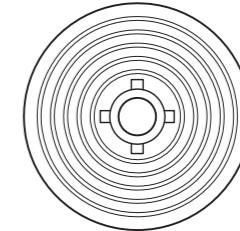
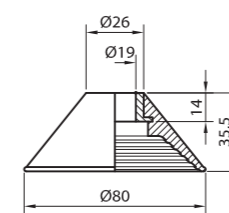
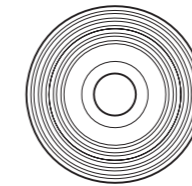
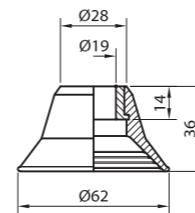
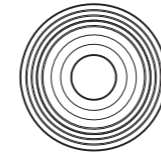
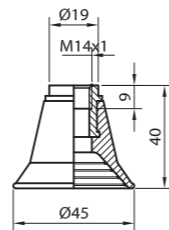
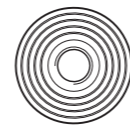
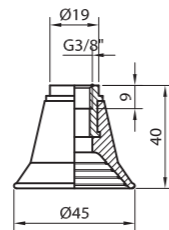
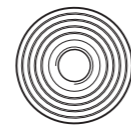

45 / 50	45 / 50	62 / 71,5	80 / 90	115 / 129
20	20	27,5	35	55
7	7	10	15,5	21,5
15	15	38	66	139
26	26	35	44	103
5,01	5,01	9,69	15,2	30,8
7,13	7,13	14,0	21,4	42,1
9,35	9,35	17,3	25,8	52,0
10,5	10,5	18,9	28,4	56,7
VSA45R3/8NIT	VSA45M14NIT	VSA62NIT	VSA80NIT	VSA115NIT